



## 385-386-387型蝶阀

### ITEM 385-386-387

Butterfly valve to be inserted between flanges,  
“Lug” type

凸耳式蝶阀, “Lug” 型

#### Standard executions:

Available range: from DN 40 to DN 300  
PN 10 - PN 16  
Standard flanges: PN10 = PN16 - from DN 40 to DN 150;  
PN 10 or PN 16 from DN 200 to DN 300.  
Face to face as per EN558-1 series 20  
Valve head as per ISO 5211:2003  
Tightness as per EN 12266-1 rate A

Other tests on request:  
Working temperature:

EPDM from -40°C to +135°C  
NBR from -23°C to +82°C  
VITON from -10°C to +190°C  
PTFE from -25°C to +150°C

Working pressure between flanges:  
PN 16 bar for DN 40 to DN 150  
PN 10 or PN 16 bar for DN 200 to DN 300

#### 执行标准:

适用范围: DN 40至DN 300 PN 10 - PN 16  
法兰标准: DN 40至DN 150 PN 10 = PN 16  
DN 200至DN 300 PN 10 或PN 16

结构长度符合 EN 558-1 20系列标准  
阀门头符合 ISO 5211:2003标准  
泄漏等级符合 EN 12266-1 A级

其他测试根据要求。  
工作温度:

乙丙橡胶EPDM -40°C 至 +135°C  
丁腈橡胶NBR -23°C 至 +82°C  
氟橡胶VITON -10°C 至 +190°C  
聚四氟乙烯PTFE -25°C 至 +150°C

法兰工作压力: :  
DN 40 至 DN 150 PN 16 bar  
DN 200 至 DN 300 PN 10 bar 或 PN 16 bar

#### On request:

Working temperature: SILICONE from -50°C to +160°C  
NBR CARBOX from -10°C to +82°C  
NBR WHITE for food from -23°C to +82°C  
HNBR from -30°C to +100°C

For other applications, please contact our technical department.

#### 可选:

工作温度: 硅胶 -50°C 至 +160°C  
NBR CARBOX -10°C 至 +82°C  
白色丁腈橡胶 -23°C 至 +82°C  
HNBR -30°C 至 +100°C

其他应用, 请与我们技术部门联系。

#### Approvals:

According to 97/23 EC “PED”  
DVGW homologation for gas (V385-V386)  
RINA homologation  
suitabilities to the contact with water and alimentary fluid (V386)  
ATEX directive 94/9/EC on request

#### 证书:

97/23 EC “PED” 认证  
DVGW 气体认证 (V385-V386)  
RINA 认证  
适用于过水和管道流体介质 (V386)  
特殊要求的ATEX认证 (94/9/EC认证)

## VALVE TYPE 385-386-387 WITH FREE SHAFT 385-386-387型阀体

### VALVE CODES FREE SHAFT IN STANDARD EXECUTION 标准型阀体订货号

BUTTERFLY 閥板	CAST IRON 球墨鑄鐵			AISI 316 不銹鋼316				BRONZE ALUMINIUM 鋁青銅		
	LINER 密封	EPDM	NBR	VITON	EPDM	NBR	VITON	PTFE	EPDM	NBR
DN 40 PN 10-16	V385XE68	V385XN68	V385XV68	V386XE68	V386XN68	V386XV68	V386XT68	V387XE68	V387XN68	
DN 50 PN 10-16	V385XE69	V385XN69	V385XV69	V386XE69	V386XN69	V386XV69	V386XT69	V387XE69	V387XN69	
DN 65 PN 10-16	V385XE70	V385XN70	V385XV70	V386XE70	V386XN70	V386XV70	V386XT70	V387XE70	V387XN70	
DN 80 PN 10-16	V385XE71	V385XN71	V385XV71	V386XE71	V386XN71	V386XV71	V386XT71	V387XE71	V387XN71	
DN 100 PN 10-16	V385XE72	V385XN72	V385XV72	V386XE72	V386XN72	V386XV72	V386XT72	V387XE72	V387XN72	
DN 125 PN 10-16	V385XE73	V385XN73	V385XV73	V386XE73	V386XN73	V386XV73	V386XT73	V387XE73	V387XN73	
DN 150 PN 10-16	V385XE74	V385XN74	V385XV74	V386XE74	V386XN74	V386XV74	V386XT74	V387XE74	V387XN74	
DN 200 PN 16	V385FE75	V385FN75	V385FV75	V386FE75	V386FN75	V386FV75	V386FT75	V387FE75	V387FN75	
DN 250 PN 16	V385FE76	V385FN76	V385FV76	V386FE76	V386FN76	V386FV76	V386FT76	V387FE76	V387FN76	
DN 300 PN 16	V385FE77	V385FN77	V385FV77	V386FE77	V386FN77	V386FV77	V386FT77	V387FE77	V387FN77	
DN 200 PN 10	V385KE75	V385KN75	V385KV75	V386KE75	V386KN75	V386KV75	V386KT75	V387KE75	V387KN75	
DN 250 PN 10	V385KE76	V385KN76	V385KV76	V386KE76	V386KN76	V386KV76	V386KT76	V387KE76	V387KN76	
DN 300 PN 10	V385KE77	V385KN77	V385KV77	V386KE77	V386KN77	V386KV77	V386KT77	V387KE77	V387KN77	

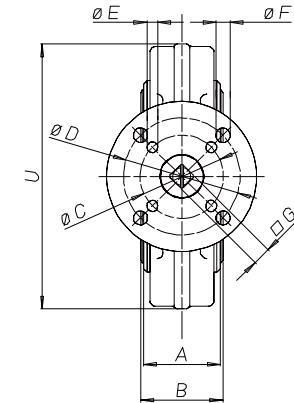
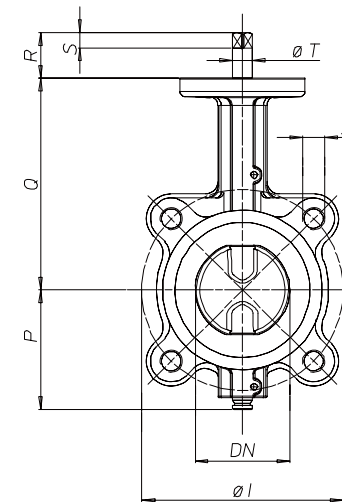

A: Face to face 结构长度

B: Liner not compressed 未压缩的衬垫

### DIMENSIONS 尺寸表

Size 口径	A	B	C	D	E	F	G	I	P	Q	R	S	T	U	Z	Holes 孔数
DN 40 PN 10-16	33	36	50	70	6,5	8,5	9	110	70	125	31	9	14,2	118	M16	4
DN 50 PN 10-16	43	46	50	70	6,5	8,5	9	125	80	140	31	9	14,2	125	M16	4
DN 65 PN 10-16	46	49	50	70	6,5	8,5	11	145	86	152	33	11	14,2	139	M16	4
DN 80 PN 10-16	46	49	50	70	6,5	8,5	11	160	95,5	159	33	11	14,2	184	M16	8
DN100 PN 10-16	52	56	50	70	6,5	8,5	11	180	108	178	33	11	14,2	204	M16	8
DN125 PN 10-16	56	59	70		8,5		14	210	124,5	190,5	36	14	19	230	M16	8
DN150 PN 10-16	56	59	70		8,5		14	240	137	203	36	14	19	266	M20	8
DN 200 PN 16	60	64	70		8,5		17	295	166	238	39	17	22,2	329	M20	12
DN 250 PN 16	68	72	102	125	11	13	22	355	199	268	55	22	28,5	395	M24	12
DN 300 PN 16	78	81,5	102	125	11	13	22	410	234	306	55	22	28,5	448	M24	12
DN 200 PN 10	60	64	70		8,5		17	295	166	238	39	17	22,2	318	M20	8
DN 250 PN 10	68	72	102	125	11	13	17	350	199	268	50	17	28,5	395	M20	12
DN 300 PN 10	78	81,5	102	125	11	13	22	400	234	306	55	22	28,5	448	M20	12

## VALVE TYPE 385-386-387 WITH LEVER 385-386-387型手动蝶阀

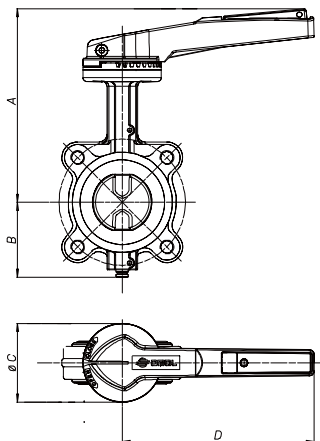

Size 口径	AA	B	C	D	Kg
DN 40	188	70	90	160	2,5
DN 50	203	80	90	160	3,4
DN 65	225	86	90	220	4,3
DN 80	230	95,5	90	220	5,5
DN 100	250	108	90	220	6,6
DN 125	277	124,5	90	350	9
DN 150	290	137	90	350	11,4
DN 200	325	166	90	350	17,5
DN 250	390	199	175	500	26,8
DN 300	426	234	175	500	41,8

### VALVE CODE WITH LEVER 手动蝶阀订货号

BUTTERFLY 阀板	CAST IRON 球墨铸铁			AISI 316 不锈钢316				BRONZE-ALUMINIUM 铝青铜		LEVER 手柄
LINER 密封	EPDM	NBR	VITON	EPDM	NBR	VITON	PTFE	EPDM	NBR	
DN 40 PN 10-16	L385XE68	L385XN68	L385XV68	L386XE68	L386XN68	L386XV68	L386XT68	L387XE68	L387XN68	KLW37569
DN 50 PN 10-16	L385XE69	L385XN69	L385XV69	L386XE69	L386XN69	L386XV69	L386XT69	L387XE69	L387XN69	KLW37569
DN 65 PN 10-16	L385XE70	L385XN70	L385XV70	L386XE70	L386XN70	L386XV70	L386XT70	L387XE70	L387XN70	KLW37570
DN 80 PN 10-16	L385XE71	L385XN71	L385XV71	L386XE71	L386XN71	L386XV71	L386XT71	L387XE71	L387XN71	KLW37570
DN 100 PN 10-16	L385XE72	L385XN72	L385XV72	L386XE72	L386XN72	L386XV72	L386XT72	L387XE72	L387XN72	KLW37570
DN 125 PN 10-16	L385XE73	L385XN73	L385XV73	L386XE73	L386XN73	L386XV73	L386XT73	L387XE73	L387XN73	KLW37573
DN 150 PN 10-16	L385XE74	L385XN74	L385XV74	L386XE74	L386XN74	L386XV74	L386XT74	L387XE74	L387XN74	KLW37573
DN 200 PN 16	L385FE75	L385FN75	L385FV75	L386FE75	L386FN75	L386FV75	L386FT75	L387FE75	L387FN75	KLW37575
DN 250 PN 16	L385FE76	L385FN76	L385FV76	L386FE76	L386FN76	L386FV76	L386FT76	L387FE76	L387FN76	KLW37576
DN 300 PN 16	L385FE77	L385FN77	L385FV77	L386FE77	L386FN77	L386FV77	L386FT77	L387FE77	L387FN77	KLW37576
DN 200 PN 10	L385KE75	L385KN75	L385KV75	L386KE75	L386KN75	L386KV75	L386KT75	L387KE75	L387KN75	KLW37575
DN 250 PN 10	L385KE76	L385KN76	L385KV76	L386KE76	L386KN76	L386KV76	L386KT76	L387KE76	L387KN76	KLW37576
DN 300 PN 10	L385KE77	L385KN77	L385KV77	L386KE77	L386KN77	L386KV77	L386KT77	L387KE77	L387KN77	KLW37576

### LEVER FEATURES 手柄特性

10-position lever; lockable in each position  
Material: Aluminium  
Surface coating: polyester  
Weight: from 0,3 to 0,9 Kg

**10个可锁位置**  
材质: 铝手柄  
表面处理: 聚酯  
重量: 0.3-0.9 Kg

### BREAK AWAY TORQUES in Nm 扭矩 Nm

Size 口径	DN 40	DN 50	DN 65	DN 80	DN 100	DN 125	DN 200	DN 250	DN 300						
PN 10 bar	15	15	17	19	27	36	54	109	218						
PN 16 bar	18	18	25	27	35	52	72	142	250						

Torque can vary depending on temperature and type of fluid; a safety factor of 1.4 must be applied. Torque can drop on high frequency of operations.  
开启扭矩与温度和介质有关, 应用时应考虑1.4倍的安全系数。在高频率 操作下扭矩值会下降。

## VALVE TYPE 385-386-387 WITH GEAR BOX 385-386-387型蜗轮蝶阀

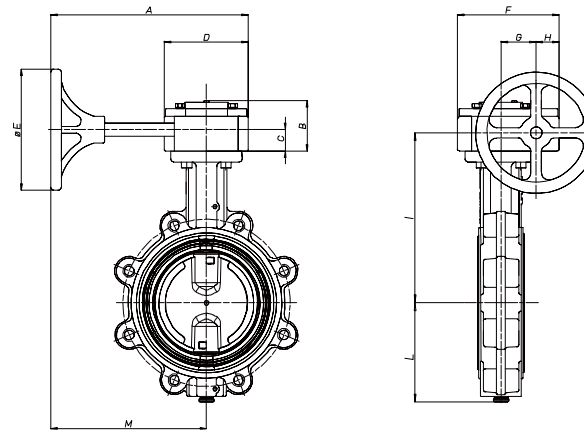

### GEAR BOX FEATURES

Reliable device working by means of pinion and worm screw.  $\pm 5^\circ$  possible adjustment in both directions, without having to disassemble anything.  
An arrow indicates the position of the valve.  
Body in cast iron GGG40.  
Worm screw and bush in treated steel.  
Handwheel in Aluminium.  
Epoxy-painted surface.

### 蜗轮箱特性

可靠的工作性能, 蜗轮蜗杆能在 $\pm 5^\circ$ 内双向调节, 无需拆卸任何部件。  
箭头指示阀门位置。  
阀体材质为球墨铸铁GGG40。  
手轮材质为铝。  
表面环氧树脂喷涂。

### VALVE CODE WITH GEAR BOX 蜗轮蝶阀订货号

BUTTERFLY 阀板	CAST IRON 球墨铸铁			AISI 316 不锈钢316				BRONZE-ALUMINIUM 铝青铜		GEAR BOX 蜗轮箱
LINER 密封	EPDM	NBR	VITON	EPDM	NBR	VITON	PTFE	EPDM	NBR	
DN 40 PN 10-16	R385XE68	R385XN68	R385XV68	R386XE68	R386XN68	R386XV68	R386XT68	R387XE68	R387XN68	RW006W69
DN 50 PN 10-16	R385XE69	R385XN69	R385XV69	R386XE69	R386XN69	R386XV69	R386XT69	R387XE69	R387XN69	RW006W69
DN 65 PN 10-16	R385XE70	R385XN70	R385XV70	R386XE70	R386XN70	R386XV70	R386XT70	R387XE70	R387XN70	RW006W70
DN 80 PN 10-16	R385XE71	R385XN71	R385XV71	R386XE71	R386XN71	R386XV71	R386XT71	R387XE71	R387XN71	RW006W70
DN 100 PN 10-16	R385XE72	R385XN72	R385XV72	R386XE72	R386XN72	R386XV72	R386XT72	R387XE72	R387XN72	RW006W70
DN 125 PN 10-16	R385XE73	R385XN73	R385XV73	R386XE73	R386XN73	R386XV73	R386XT73	R387XE73	R387XN73	RW006W73
DN 150 PN 10-16	R385XE74	R385XN74	R385XV74	R386XE74	R386XN74	R386XV74	R386XT74	R387XE74	R387XN74	RW006W73
DN 200 PN 16	R385FE75	R385FN75	R385FV75	R386FE75	R386FN75	R386FV75	R386FT75	R387FE75	R387FN75	RW007W75
DN 250 PN 16	R385FE76	R385FN76	R385FV76	R386FE76	R386FN76	R386FV76	R386FT76	R387FE76	R387FN76	RW007W76
DN 300 PN 16	R385FE77	R385FN77	R385FV77	R386FE77	R386FN77	R386FV77	R386FT77	R387FE77	R387FN77	RW007W76
DN 200 PN 10	R385KE75	R385KN75	R385KV75	R386KE75	R386KN75	R386KV75	R386KT75	R387KE75	R387KN75	RW007W75
DN 250 PN 10	R385KE76	R385KN76	R385KV76	R386KE76	R386KN76	R386KV76	R386KT76	R387KE76	R387KN76	RW007W76
DN 300 PN 10	R385KE77	R385KN77	R385KV77	R386KE77	R386KN77	R386KV77	R386KT77	R387KE77	R387KN77	RW007W76

### DIMENSIONS 尺寸表

Size 口径	A	B	C	D	E	F	G	H	I	L	M							Kg
DN 40 PN 10-16	245	64	27	106	152	128,5	45	30	166,5	73	192							6,2
DN 50 PN 10-16	245	64	27	106	152	128,5	45	30	166,5	73	192							7,1
DN 65 PN 10-16	245	64	27	106	152	128,5	45	30	179,5	80	192							7,9
DN 80 PN 10-16	245	64	27	106	152	128,5	45	30	186	86	192							9,1
DN 100 PN 10-16	245	64	27	106	152	128,5	45	30	178	103,5	192							10,2
DN 125 PN 10-16	245	64	27	106	152	128,5	45	30	217,5	118	192							12,3
DN 150 PN 10-16	245	64	27	106	152	128,5	45	30	230	132	192							14,7
DN 200 PN 16	320	80	34	155	320	180	66	36	272,5	162,5	243							27,8
DN 250 PN 16	320	80	34	155	320	180	66	36	302,5	194,5	243							36
DN 300 PN 16	320	80	34	155	320	180	66	36	340,5	226,5	243							51,3
DN 200 PN 10	320	80	34	155	320	180	66	36	272,5	162,5	243							27,8
DN 250 PN 10	320	80	34	155	320	180	66	36	302,5	194,5	243							36
DN 300 PN 10	320	80	34	155	320	180	66	36	340,5	226,5	243							51,3



## AUTOMATED VALVE TYPE 385-386-387 385-386-387型气动蝶阀

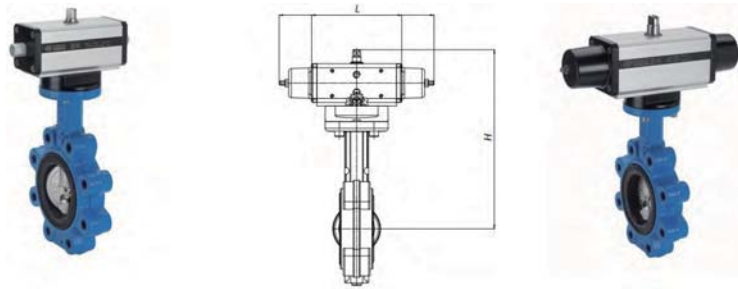

VALVE WITH DOUBLE ACTING PNEUMATIC ACTUATOR 双气动蝶阀														
	DN 40	DN 50	DN 65	DN 80	DN 100	DN 125	DN 150	DN 200	DN 250	DN 300		DN 200	DN 250	DN 300
	PN 10-16	PN 10-16	PN 10-16	PN 10-16	PN 10-16	PN 10-16	PN 10-16	PN 16	PN 16	PN 16		PN 10	PN 10	PN 10
Lmm	168	168	182	182	190	225	240	314	336	365		268	314	336
Hmm	242	242	260	267	290	310	342	397	449	500		387	438	488
Kg.	3,3	4,2	5	6,2	7,6	9,9	12,6	22,2	32,3	48,8		20,3	30,4	47,6

VALVE WITH SPRING RETURN PNEUMATIC ACTUATOR 单气动蝶阀														
	DN 40	DN 50	DN 65	DN 80	DN 100	DN 125	DN 150	DN 200	DN 250	DN 300		DN 200	DN 250	DN 300
	PN 10-16	PN 10-16	PN 10-16	PN 10-16	PN 10-16	PN 10-16	PN 10-16	PN 16	PN 16	PN 16		PN 10	PN 10	PN 10
Lmm	240	240	294	294	320	357	368	456	566	602		436	456	566
Hmm	252	252	272	279	316	339	362	421	479	523		408	461	518
Kg.	4,3	5,2	6	7,2	8,7	11,9	15,4	27,9	41	59,6		26,3	36,1	56,3

BODY IN CAST IRON 阀体球墨铸铁										
BUTTERFLY 阀板	CAST IRON 球墨铸铁			AISI 316 不锈钢316				BRONZE-ALUMINIUM 铝青铜		ACTUATOR 执行器
LINER 密封	EPDM	NBR	VITON	EPDM	NBR	VITON	PTFE	EPDM	NBR	
DN 40 PN 10-16	D385XE68 S385XE68	D385XN68 S385XN68	D385XV68 S385XV68	D386XE68 S386XE68	D386XN68 S386XN68	D386XV68 S386XV68	D386XT68 S386XT68	D387XE68 S387XE68	D387XN68 S387XN68	DA 30 SR 30
DN 50 PN 10-16	D385XE69 S385XE69	D385XN69 S385XN69	D385XV69 S385XV69	D386XE69 S386XE69	D386XN69 S386XN69	D386XV69 S386XV69	D386XT69 S386XT69	D387XE69 S387XE69	D387XN69 S387XN69	DA 30 SR 30
DN 65 PN 10-16	D385XE70 S385XE70	D385XN70 S385XN70	D385XV70 S385XV70	D386XE70 S386XE70	D386XN70 S386XN70	D386XV70 S386XV70	D386XT70 S386XT70	D387XE70 S387XE70	D387XN70 S387XN70	DA 45 SR 45
DN 80 PN 10-16	D385XE71 S385XE71	D385XN71 S385XN71	D385XV71 S385XV71	D386XE71 S386XE71	D386XN71 S386XN71	D386XV71 S386XV71	D386XT71 S386XT71	D387XE71 S387XE71	D387XN71 S387XN71	DA 45 SR 45
DN 100 PN 10-16	D385XE72 S385XE72	D385XN72 S385XN72	D385XV72 S385XV72	D386XE72 S386XE72	D386XN72 S386XN72	D386XV72 S386XV72	D386XT72 S386XT72	D387XE72 S387XE72	D387XN72 S387XN72	DA 60 SR 60
DN 125 PN 10-16	D385XE73 S385XE73	D385XN73 S385XN73	D385XV73 S385XV73	D386XE73 S386XE73	D386XN73 S386XN73	D386XV73 S386XV73	D386XT73 S386XT73	D387XE73 S387XE73	D387XN73 S387XN73	DA 90 SR 90
DN 150 PN 10-16	D385XE74 S385XE74	D385XN74 S385XN74	D385XV74 S385XV74	D386XE74 S386XE74	D386XN74 S386XN74	D386XV74 S386XV74	D386XT74 S386XT74	D387XE74 S387XE74	D387XN74 S387XN74	DA 120 SR 120
DN 200 PN 16	D385FE75 S385FE75	D385FN75 S385FN75	D385FV75 S385FV75	D386FE75 S386FE75	D386FN75 S386FN75	D386FV75 S386FV75	D386FT75 S386FT75	D387FE75 S387FE75	D387FN75 S387FN75	DA 240 SR 240
DN 250 PN 16	D385FE76 S385FE76	D385FN76 S385FN76	D385FV76 S385FV76	D386FE76 S386FE76	D386FN76 S386FN76	D386FV76 S386FV76	D386FT76 S386FT76	D387FE76 S387FE76	D387FN76 S387FN76	DA 360 SR 360
DN 300 PN 16	D385FE77 S385FE77	D385FN77 S385FN77	D385FV77 S385FV77	D386FE77 S386FE77	D386FN77 S386FN77	D386FV77 S386FV77	D386FT77 S386FT77	D387FE77 S387FE77	D387FN77 S387FN77	DA 480 SR 480
DN 200 PN 10	D385KE75 S385KE75	D385KN75 S385KN75	D385KV75 S385KV75	D386KE75 S386KE75	D386KN75 S386KN75	D386KV75 S386KV75	D386KT75 S386KT75	D387KE75 S387KE75	D387KN75 S387KN75	DA 180 SR 180
DN 250 PN 10	D385KE76 S385KE76	D385KN76 S385KN76	D385KV76 S385KV76	D386KE76 S386KE76	D386KN76 S386KN76	D386KV76 S386KV76	D386KT76 S386KT76	D387KE76 S387KE76	D387KN76 S387KN76	DA 240 SR 240
DN 300 PN 10	D385KE77 S385KE77	D385KN77 S385KN77	D385KV77 S385KV77	D386KE77 S386KE77	D386KN77 S386KN77	D386KV77 S386KV77	D386KT77 S386KT77	D387KE77 S387KE77	D387KN77 S387KN77	DA 360 SR 360

## AUTOMATED VALVE TYPE 385-386-387 385-386-387型电动蝶阀

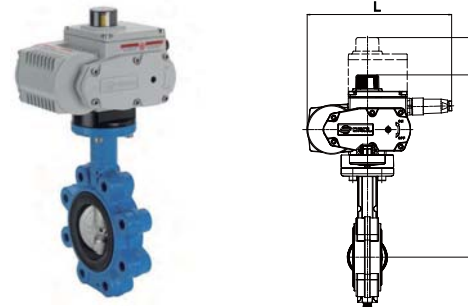

230Vac version code are showed in table below.  
To order valves with "NEW GENERATION"  
MODULATING ACTUATORS (part number starting  
with letter "C") the actuator configuration is  
necessary. According to section A3

230Vac电动蝶阀订货号见下表。  
订购配套新型调节型电动执行器（订货号以字母C开头）  
的电动蝶阀，执行器配置是必需的，参考电动执行器  
相关内容。

VALVE WITH ON-OFF ELECTRIC ACTUATOR 开关型电动蝶阀														
	DN 40	DN 50	DN 65	DN 80	DN 100	DN 125	DN 150	DN 200	DN 250	DN 300		DN 200	DN 250	DN 300
	PN 10-16	PN 10-16	PN 10-16	PN 10-16	PN 10-16	PN 10-16	PN 10-16	PN 16	PN 16	PN 16		PN 10	PN 10	PN 10
Lmm	213	213	213	213	213	213	229,5	229,5	256,5	381		229,5	229,5	256,5
Hmm	284,1	298,8	314,2	317,8	336,9	349,6	383	418	486,4	573,5		418	459	524,5
Kg.	6	6,9	7,6	8,8	10,2	12,2	18	24,4	33,2	60,9		24,4	34,1	49,4

VALVE WITH ROTARY MODULATING ELECTRIC ACTUATOR 调节型电动蝶阀														
	DN 40	DN 50	DN 65	DN 80	DN 100	DN 125	DN 150	DN 200	DN 250	DN 300		DN 200	DN 250	DN 300
	PN 10-16	PN 10-16	PN 10-16	PN 10-16	PN 10-16	PN 10-16	PN 10-16	PN 16	PN 16	PN 16		PN 10	PN 10	PN 10
Lmm	213	213	213	213	213	213	229,5	229,5	381	381		229,5	229,5	381
Hmm	347,9	362,6	378	381,6	400,7	413,4	446,8	481,8	535,4	573,5		481,8	522,8	573,5
Kg.	6,6	7,5	8,3	9,5	10,8	12,9	18,6	25	47,9	63,2		25	33,2	63,2

BODY IN CAST IRON 阀体球墨铸铁										
BUTTERFLY 阀板	CAST IRON 球墨铸铁			AISI 316 不锈钢316				BRONZE-ALUMINIUM 铝青铜		ACTUATOR 执行器
LINER 密封	EPDM	NBR	VITON	EPDM	NBR	VITON	PTFE	EPDM	NBR	
DN 40 PN 10-16	C385EA5E68	C385NA5E68	C385VA5E68	C386EA5E68	C386NA5E68	C386VA5E68	C386TA5E68	C387EA5E68	C387NA5E68	EA 35
DN 50 PN 10-16	C385EA5E69	C385NA5E69	C385VA5E69	C386EA5E69	C386NA5E69	C386VA5E69	C386TA5E69	C387EA5E69	C387NA5E69	EA 35
DN 65 PN 10-16	C385EA5E70	C385NA5E70	C385VA5E70	C386EA5E70	C386NA5E70	C386VA5E70	C386TA5E70	C387EA5E70	C387NA5E70	EA 35
DN 80 PN 10-16	C385EA5E71	C385NA5E71	C385VA5E71	C386EA5E71	C386NA5E71	C386VA5E71	C386TA5E71	C387EA5E71	C387NA5E71	EA 35
DN 100 PN 10-16	C385EA5G72	C385NA5G72	C385VA5G72	C386EA5G72	C386NA5G72	C386VA5G72	C386TA5G72	C387EA5G72	C387NA5G72	EA 70
DN 125 PN 10-16	C385EA5G73	C385NA5G73	C385VA5G73	C386EA5G73	C386NA5G73	C386VA5G73	C386TA5G73	C387EA5G73	C387NA5G73	EA 70
DN 150 PN 10-16	C385EA5I74	C385NA5I74	C385VA5I74	C386EA5I74	C386NA5I74	C386VA5I74	C386TA5I74	C387EA5I74	C387NA5I74	EA 130
DN 200 PN 16	C385EFA5K75	C385NFA5K75	C385VFA5K75	C386EFA5K75	C386NFA5K75	C386VFA5K75	C386TFA5K75	C387EFA5K75	C387NFA5K75	EA 240
DN 250 PN 16	E385EF16N76 M385EF16P76	E385NF16N76 M385NF16P76	E385VF16N76 M385VF16P76	E386EF16N76 M386EF16P76	E386NF16N76 M386NF16P76	E386VF16N76 M386VF16P76	E386TF16N76 M386TF16P76	E387EF16N76 M386EF16P76	E387NF16N76 M386NF16P76	AE 400 AM 500
DN 300 PN 16	E385EF16R77 M385EF16P77	E385NF16R77 M385NF16P77	E385VF16R77 M385VF16P77	E386EF16R77 M386EF16P77	E386NF16R77 M386NF16P77	E386VF16R77 M386VF16P77	E386TF16R77 M386TF16P77	E387EF16R77 M386EF16P77	E387NF16R77 M386NF16P77	AE 600 AM 500
DN 200 PN 10	C385EKA5K75	C385NKA5K75	C385VKA5K75	C386EKA5K75	C386NKA5K75	C386VKA5K75	C386TKA5K75	C387EKA5K75	C387NKA5K75	EA 240
DN 250 PN 10	C385EKA5K76	C385NKA5K76	C385VKA5K76	C386EKA5K76	C386NKA5K76	C386VKA5K76	C386TKA5K76	C387EKA5K76	C387NKA5K76	EA 240
DN 300 PN 10	E385EK16N77 M385EK16P77	E385NK16N77 M385NK16P77	E385VK16N77	E386EK16N77 M386EK16P77	E386NK16N77 M386NK16P77	E386VK16N77 M386NK16P77	E386TK16N77 M386TK16P77	E387EK16N77 M387EK16P77	E387NK16N77 M387NK16P77	AE 400 AM 500